



## 7 May Gardens

, Wishaw, ML2 7PB

### Offers over £115,000

**CLOSING DATE SET!**  
THURSDAY 12TH FEBRUARY AT NOON

This spacious and impressive first floor apartment is situated within a sought-after modern development central to all of Wishaws amenities.

The building, comprising 19 properties, has the additional benefit of a lift providing access to all levels.

The accommodation has been finished with fresh neutral décor throughout and comprises a welcoming reception hallway, an extremely spacious lounge benefitting from a wealth of natural light flooding in from the triple window aspect with ample space for dining and entertaining, a modern kitchen with integrated appliances, double bedroom with en suite facilities and separate wet room.

Further features include storage, gas central heating, double glazing, designated parking bay, secure door entry system and communal gardens.

The property is located extremely close of Wishaw town centre with a wide range of amenities on offer locally, such as restaurants, shopping facilities and sports amenities including the golf course, swimming baths, gyms and parks. There are several highly regarded schools. For those commuting by public transport there are regular bus and train links to

- Stunning and Spacious First Floor Apartment
- Lift Facilities
- Large Double Bedroom with En Suite facilities
- Bright Open Plan Lounge and Dining Area
- Designated Parking
- Secure Door Entry System
- Communal Landscaped Gardens
- Central for all amenities
- Modern Kitchen

### Viewing

Please contact our Pomphreys Properties Ltd Office on 01698373365 if you wish to arrange a viewing appointment for this property or require further information.



## Floor Plan

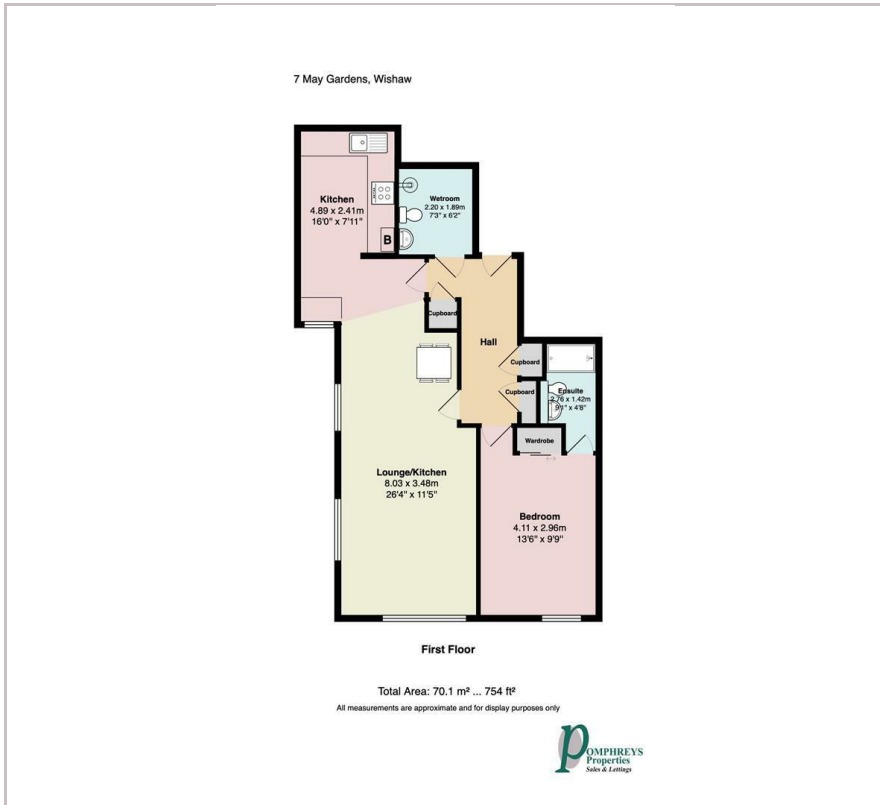

## Area Map



## Energy Efficiency Graph



These particulars, whilst believed to be accurate are set out as a general outline only for guidance and do not constitute any part of an offer or contract. Intending purchasers should not rely on them as statements of representation of fact, but must satisfy themselves by inspection or otherwise as to their accuracy. No person in this firm's employment has the authority to make or give any representation or warranty in respect of the property.